

Ø 16 x 26 mm

- Wall-mounted door buffer in solid, germ-reducing and easy-care stainless steel (AISI 303), satin finished.
- Concealed, centric, anti-theft wall mounting.
- Holder diameter 16 mm
Length 26 mm
- With rubber buffer.
- Mounting with one screw.
- Delivery includes fixing material.
- Weight, including single package: 0.1 kg



Suggested text for specifications:

Wall-mounted door buffer in solid stainless steel (AISI 303), satin finished, with rubber buffer, for surface mounting. Concealed, centric, anti-theft wall mounting. Delivery includes fixing material.

Dimensions: Ø 16 x 26 mm

Article No. AC219

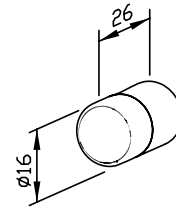

Available surface	ID No.
satin finished	700 219